



ALBA

Length: 30.00 metres (98' 5")

Beam: 7.14 metres (23' 5")

Draft: 3.0 metres (9' 10")

Number of Guests: 10

Number of Crew: 4

Built: 1997

Refit: 2014

Flag: Croatia

Hull Construction: Wood

Hull Configuration: Displacement

Air conditioning, WiFi connection on board

Excellent indoor and fantastic outdoor space for 10 guests, comfort and style, attentive service of her dedicated crew - these are regular impressions of Alba's guests.

Dedicated to provide her guests fully relaxed tailor made holidays, but secretly aiming to amaze them, this might be the best definition of her goals.

Alba seriously takes holidays of her guests, leaving to them just to enjoy and relax.

Upon completed renovation in 2014 this originally private yacht started her charter career.

Often described as motor yacht looking gulet, Alba indeed combines comfort of sailing gulet tastefully borrowing motor yacht design.

Alba accommodates up to 10 guests in 5 en-suite cabins; Master cabin with double bed and twin cabin, placed in aft area of lower deck while VIP double bed cabin and two regular double beds are situated in the front. Galley and inside dining area are also placed below deck. For that reason, salon with bar and steering place takes smaller area of main deck allowing maximal use her exterior main deck for relaxation and enjoyment in different sections. Al fresco dining area at the stern deck, fully protected from sun comfortably seats 10 guests around dinning table; behind it an area with sun chairs and cocktail table. Front part of main deck offers excellent space; inviting to relax on mattresses in front of the salon or for a comfortable chilling of whole party in the mid-deck lounge area. In addition to that, fly bridge with sofas and sun mattresses is perfect area to spend private moments. Choice of water sport activities secured; there are wave runner, water ski, kayak, stand up paddle board and snorkeling equipment on board. Excellent and creative chef on board, selecting freshest and seasonal ingredients creates personalized menus for each charter party. Welcoming and warm service of Alba's 4 crew members completes perfect holidays on this beautiful gulet.

KEY FEATURES

- 1** uniquely exclusive in her price range
- 2** excellent outdoor space
- 3** diverse exterior areas
- 4** choice of water sport activities
- 5** accommodating 10 guests in 5 cabins
- 6** spacious Master cabin and VIP cabin









Fly bridge



Fly bridge



salon



salon



indoor dining area



indoor dining area



master cabin



master cabin



master cabin bathroom



VIP cabin



VIP cabin bathroom



double room 1



double room 2



bathroom



twin room



twin room

SPECIFICATIONS

ACCOMMODATION

Number of Guests: 10

Number of Cabins: 5

Cabin Configuration: 4 Double, 1 Twin

Bed Configuration: 1 King, 3 Double, 2 Single

EQUIPMENT

Engines: Engine: 1 diesel motor CATEPILLAR 312 Kw

Generator: ONAN 17,5 kW

Cruising Speed: 9 knots

WATERSPORTS

Tenders + Toys: TENDER: 5 m, 60 HP

Jet Ski, Stand up Paddle Board, snorkeling sets

LAYOUT

GLAVNA PALUBA
MAIN DECK

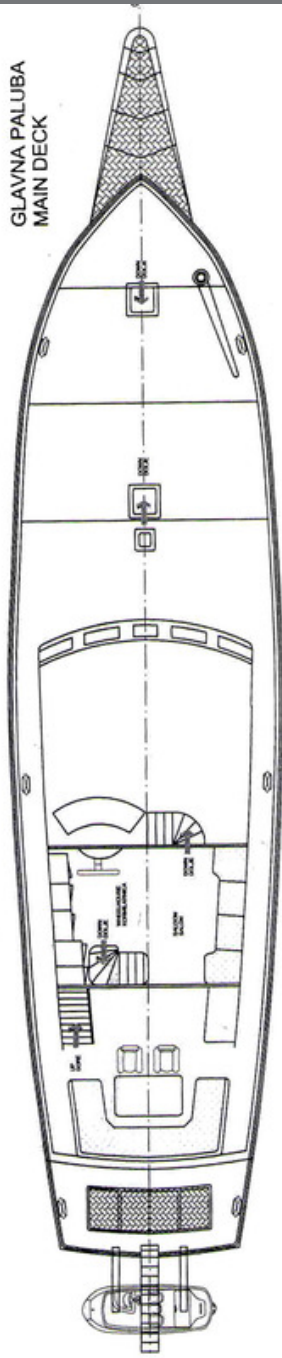

PALUBA KABINA
CABIN DECK

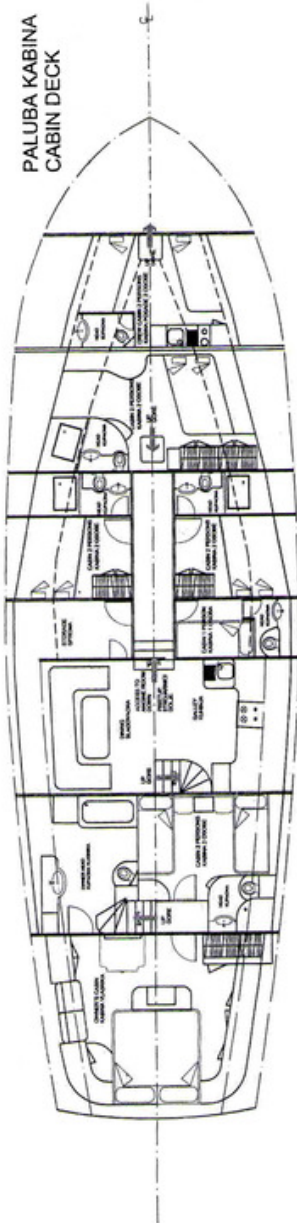

PALUBA STROJARNICE
ENGINE DECK

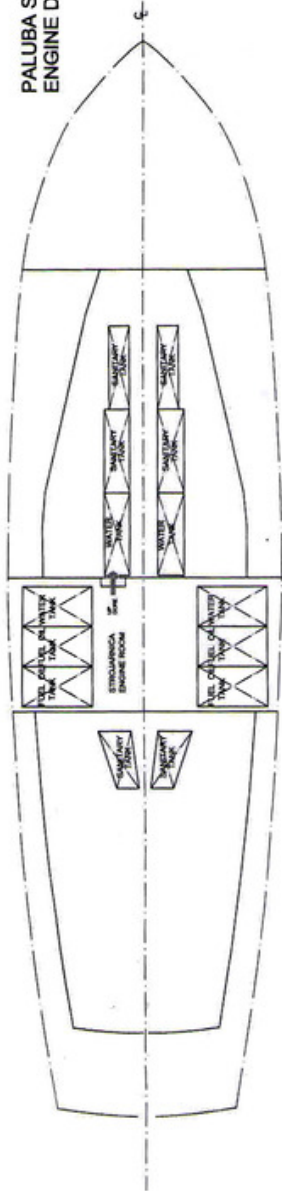

SUNČANA PALUBA
SUN DECK

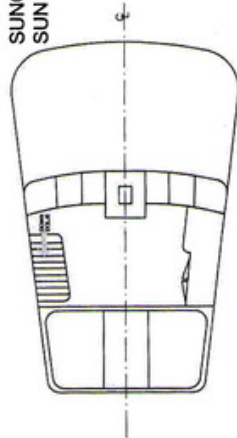

Disclaimer

This document is not contractual. All specifications are given in good faith and offered for informational purposes only. The publisher and company do not warrant or assume any legal liability or responsibility for the accuracy, completeness, or usefulness of any information and/or images displayed. Yacht inventory, specifications and charter prices are subject to change without prior notice. None of the text and/or images used in this brochure may be reproduced without written consent from the publisher.